

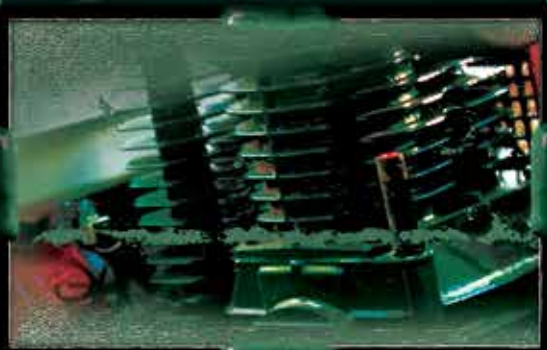

⚠ WARNING

OUR FOCUS IS COMPRESSORS.
Nothing else matters.

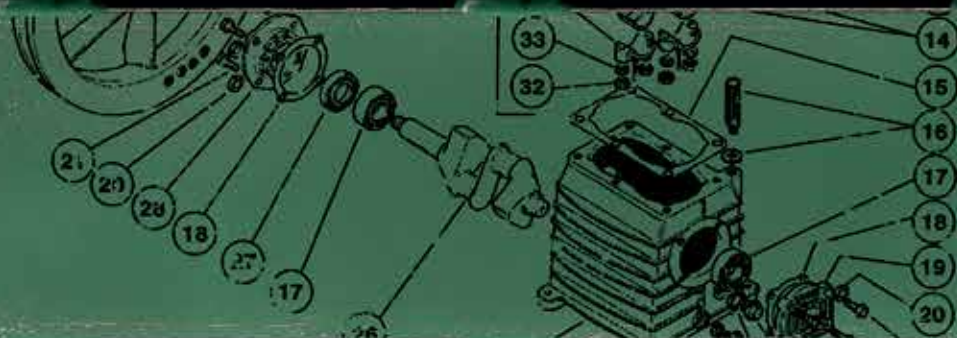

ROLAIR
SYSTEMS



If you're like most serious contractors, you're busting your butt every day. You're doing whatever it takes to get the job done on time and on budget. Your work ethic is unquestioned, your track record for reliability is nothing short of remarkable. You've got an old-school approach, and we've got nothing but respect for it.

That's why we know that the last thing you need by your side is some gimmicky, new, big-name compressor that will be calling in sick at the first sight of heavy duty labor. You need a compressor with enough guts and determination to pull through in even the most challenging work environments. A compressor that won't quit on you after a season, or be in the repair shop every other month.

You know what you need. And so do we. It isn't a bunch of excuses from a company that added an unproven compressor line to their tool empire a few years back. You need solid compressors from a company whose sole focus for decades has been exclusively compressors. It's time to belly up to the bar and make the right call, the only call.

Rolair Compressors.

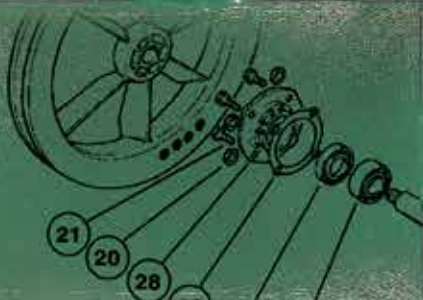

AIR HOSE

PART #	MATERIAL	LENGTH	BODY SIZE	FITTINGS	PSI Rating
1450NOODLE	Hybrid (Poly/Rubber/PVC)	50'	1/4"	Yes	300
14100NOODLE	Hybrid (Poly/Rubber/PVC)	100'	1/4"	Yes	300
3850NOODLE	Hybrid (Poly/Rubber/PVC)	50'	3/8"	Yes	300
38100NOODLE	Hybrid (Poly/Rubber/PVC)	100'	3/8"	Yes	300
1450POLY	Polyurethane	50'	1/4"	Yes	200
14100POLY	Polyurethane	100'	1/4"	Yes	200
38100POLY	Polyurethane	100'	3/8"	Yes	200

LUBRICANTS

PART #	TYPE	CONTAINER VOLUME
PUMP OIL		
OILCOMP30W34	30W Premium	34 oz.
OILCOMP30W4L	30W Premium	1 Gal.
OILCOMP30W55GDRM	30W Premium	55 Gal.
OILBLNDSYN	Synth Blend	34 oz.
OILBLNDSYN1	Synth Blend	1 Gal.
OILSYN34	Full Synth	34 oz.
OILSYN55GDRM	Full Synth	55 Gal.
TOOL OIL		
OILTOOL8	Synth Blend	8 oz.
OILTOOL16	Synth Blend	16 oz.

MANIFOLDS

MODEL #	BODY SIZE	NPT SIZE	COUPLER QTY	MATERIAL
M-TEE2CP-14-1C	1/4"	1/4"	2	Brass
M-HEX3CP-14-1C	1/4"	1/4"	3	Brass
M-TRI3CP-14-1C	1/4"	1/4"	3	Aluminum
M-BAR3CP-14-1C	1/4"	1/4"	3	Aluminum
M-CROSS3CP-14-1C	1/4"	1/4"	3	Brass
M-BAR5CP-14-1C	1/4"	1/4"	5	Aluminum

AUXILIARY TANKS

MODEL #	TANK CAPACITY (GAL.)	MAXIMUM PSI	COUPLER BODY SIZE	PORT THREAD SIZE	LENGTH (IN.)	WIDTH (IN.)	HEIGHT (IN.)	APPROX SHIPPING WT. (LB.)
AIRKEGPLUS	10	225	1/4"	3/8"	25	12	16.25	31



AIR HOSE - **1450NOODLE**



LUBRICANTS - **OILSYN34**



MANIFOLDS - **M-HEX3CP-14-1**



AUXILIARY TANK - **AIRKEGPLUS**

HAND CARRY AIR COMPRESSORS

HAND CARRY COMPRESSORS - STANDARD FEATURES >>

- Splash Lubricated Pump
- 115 V AC Motors
- Manual Reset Overload Protection
- 135 PSI Operating Pressure on Select Models
- Regulator/Pressure Gauge
- Initial Oil Fill Included
- Cast-Iron Cylinder
- Metal Intake Filter with Replaceable Element on Select Models
- 1/4 inch Universal Quick Disconnect
- Pressure Switch with On/Off Lever



MODEL - AIRSTAK



MODEL - D2002HPV5



MODEL - JC10PLUS



MODEL - AB5PLUS



MODEL - FC2002



MODEL - JC20

MODEL - VT25BIG



MODEL - VT20TB



MODEL - FC250090L



HAND CARRY MODELS / SPECS

MODEL #	MOTOR HP	MOTOR RPM	LUBRICATION TYPE	CUBIC FT. DISPLACED	CUBIC FT. FREE AIR AT 90 PSI	TANK CAPACITY (GAL.)	LENGTH (IN.)	WIDTH (IN.)	HEIGHT (IN.)	APPROX. SHIPPING WT. (LB.)
AB5PLUS	.5	1700	Oilless	2.2	1	1	16.25	14.25	11.15	30
AIRSTAK	1	2300	Oilless	5.6	2	1.6	15.5	12	13	37
JC10PLUS	1	1700	Oilless	5.3	2.4	2.5	16.5	16.5	14	45
FC1500HS3	1.5	3400	Splash Lubr.	7.8	4.0	2.15	20	9	18	43
FC2002	2	3400	Splash Lubr.	8.7	4.1	4.3	20	15	17	62
FC2002HBP6	2	3400	Splash Lubr.	8.7	4.1	5.3	16	14	31	63
FC250090L	2	3400	Splash Lubr.	10.1	5.1	24	23	28	44	160
D2002HPV5	2	3400	Splash Lubr.	8.7	4.1	4.5	18	16	17	62
VT20ST	2	1700	Splash Lubr.	5.5	4.2	4.2	19	16	17	69
VT20TB	2	1700	Splash Lubr.	5.5	4.2	3.2	18	19	37	80
JC20	2	1700	Oilless	8.7	4.5	3	20	20	15	68
VT25BIG	2.5	3400	Splash Lubr.	9.3	6.5	5.3	29.5	18.5	42 (up)	108
GD4000PV5H	Honda GX120	118cc	Splash Lubr.	8.3	4.6	4.5	22	16	16	72

ELECTRIC AIR COMPRESSORS

ELECTRIC COMPRESSORS - STANDARD FEATURES >>

- Foam-Filled Flat-Free Tire
- Splash Lubricated Pump with Cast-Iron Cylinders for Longer Life
- Ball Bearing Crankshaft
- Pump Pre-Filled with Synthetic Blend Oil
- Oil Level Sight Gauge
- Oversized Flywheel for Extra Cooling
- Automotive-Style Bearing Inserts on Connecting Rods
- Aftercooler
- Low RPM Ball Bearing Motors
- Thermal Protection with Manual Reset
- Totally Enclosed Two-Piece Heavy-Gauge Belt Guard
- Accessory Support Bracket
- Choice of Start/Stop Control with Square D Pressure Switch or
- Constant Speed Operation for Single Stage Models
- Pressure Switch with On/Off Lever Included on 1.5 - 3 HP Single Stage Models



MODEL - 5520K17A



MODEL - 3095K18

OPTIONAL FEATURES >>

- Dual Control and Dual Voltage for Single Stage Models
- 20 Gallon ASME Receivers
- Heavy Duty On/Off Switch for 3 and 5 HP Two Stage Models
- Filter/Regulator/Lubricator Sets





MODEL - 3230K24CS



MODEL - 5230K30CS

ELECTRIC BELT-DRIVE MODELS / SPECS

MODEL #	MOTOR HP	CUBIC FT. DISP.	CU. FT. DELIVERED AT 90 PSI	STAGE	TANK CAPACITY (GAL.)	TIRE COMPOSITION	LENGTH (IN.)	WIDTH (IN.)	HEIGHT (IN.)	APPROX. SHIPPING WT. (LB.)
5715K17	1.5	10.1	7.3	Single	9	Flat-Free	46	19	28	175
5715MK103	1.5	10.1	7.3	Single	9	Flat-Free	46	19	24	170
6715K17	1.5	10.1	7.3	Single	9	Flat-Free	46	27	28	195
5520K17A	1.5	10.1	7.3	Single	20 ASME	Flat-Free	42	22	34	200
5520MK103A	1.5	10.1	7.3	Single	20 ASME	Flat-Free	42	22	34	195
6820K17D	2	12.5	8.8	Single	9	Flat-Free	46	19	28	180
3095K18	3	17.2	12.5	Single	9	Flat-Free	46	27	29	240
3230K24CS	3	18.4	12.7	Two	9	Flat-Free	46	27	29	265
5230K30CS	5	23.1	18.8	Two	9	Flat-Free	46	27	34	310

MODEL - 5715K17



DETAIL



GAS AIR COMPRESSORS

GAS COMPRESSORS - STANDARD FEATURES >>

- Foam-Filled Flat-Free Tire
- Splash Lubricated Pump with Cast-Iron Cylinders for Longer Life
- Ball Bearing Crankshaft
- Oil Level Sight Gauge
- Oversized Flywheel for Extra Cooling
- Automotive-Style Bearing Inserts on Connecting Rods
- Aftercooler
- Idle-Down Throttle Control to Reduce Fuel Consumption When Air is Not Demanded
- Totally Enclosed Two-Piece Heavy-Gauge Belt Guard
- Accessory Support Bracket
- Pump Pre-Filled with Synthetic Blend Oil
- Schmidt Belt Tightening Device



MODEL - 6590HK18



MODEL - 13GR30HK30



MODEL - GD4000PV5H



MODEL - 8230HK30

OPTIONAL FEATURES >>

- Base-Mounted Designs
- 20 Gallon ASME Receivers
- Filter/Regulator/Lubricator Sets
- Electric Start on 5.5 and 9 HP Gas Units (Standard on 13 and 20 HP Units)



MODEL - 4090HK17



DETAIL

GAS BELT-DRIVE MODELS / SPECS

MODEL #	ENGINE	ENGINE RATING	CU. FT. DISPLACED	CU. FT. DELIVERED AT 90 PSI	STAGE	TANK CAPACITY	LENGTH (IN.)	WIDTH (IN.)	HEIGHT (IN.)	APPROX. SHIPPING WT. (LB.)
GD4000PV5H	Honda (GX120)	118 cc	8.3	4.6	Single	4.5	22	16	16	72
4090HK17	Honda (GX160)	163 cc	13.1	9.3	Single	9	46	19	28	180
4090HK17/20	Honda (GX160)	163 cc	13.1	9.3	Single	20 ASME	47	22	34	200
4090HMK103	Honda (GX160)	163 cc	11.7	8.7	Single	9	46	19	24	170
4090HMK103/20	Honda (GX160)	163 cc	11.7	8.7	Single	20 ASME	47	22	34	198
6590HK18	Honda (GX200)	196 cc	17.9	13.8	Single	9	46	19	28	185
6590HK18/20	Honda (GX200)	196 cc	17.9	13.8	Single	20 ASME	47	22	34	205
1040HK18	Honda (GX270)	270 cc	18.3	14.3	Single	9	46	19	29	220
7722HK28	Honda (GX270)	270 cc	20.3	17	Two	9	46	28	30	280
7722HK28/20	Honda (GX270)	270 cc	20.3	17	Two	20 ASME	49	23	35	305
8422HK30	Honda (GX270)	270 cc	24.4	20.1	Two	9	46	28	35	290
8230HK30	Honda (GX270)	270 cc	24.4	20.1	Two	20 ASME	49	23	40	315
5GR30HK17	Honda (GX160)	163 cc	13.1	9.3	Single	30	42	22	38	250
13GR30HK30	Honda (GX390)	389 cc	29.5*	23*	Two	30	42	22	48	390
20GR60HK60	Honda (GX630)	688 cc	41*	33.7*	Two	60	64	30	50	585

*CFM Rated at 175 PSI

RIGHT AT HOME, AT WORK.

ROLAIR stationary air compressors are built to work. Each component has been subjected to rigorous testing both in the factory and out in the field. With a wide array of electric and gas models ranging from 1.5 to 20 horsepower, and tank sizes from 30 to 200 gallons, there's bound to be an option that will fit your needs.



ROLAIR® K-SERIES

- Italian-Made Pumps Built Near Torino, Italy
- Synthetic Blend ROLAIR® Pump Oil for Easier Starts and Better Performance
- Oversized Crankcase
- Automotive-Style Air Filters & Bearing Inserts
- Cast-Iron Cylinders
- Aluminum Head & Crankcase for Faster Heat Dissipation
- Machine-Balanced Flywheel

OPTIONS & ACCESSORIES

- Magnetic Starters
- Automatic Tank Drains
- Dual Controls
- 208/460 Volt Motors
- Constant Speed Operation
- Dryer Systems
- Air-Cooled Aftercoolers
- Filters, Regulators & Lubricators
- Low-Oil Shutdown





MODEL - V3160K18



MODEL - V3360K24

1.5 - 2 HP SINGLE-STAGE MODELS / SPECS

MODEL		HP	PHASE	TANK SIZE (GAL.)	MOTOR RPM	DISPL. CFM @ 100 PSI	DEL'D CFM @ 100 PSI	LENGTH (IN.)	WIDTH (IN.)	HEIGHT (IN.)	APPROX. SHIPPING WT. (LB.)
HORIZONTAL	VERTICAL										
H15130K17		1.5	Single	30	1755	10.1	6.9	42	20	37	260
	V15130K17	1.5	Single	30	1755	10.1	6.9	24	20	59	235
H15160K17		1.5	Single	60	1755	10.1	6.9	52	20	41	285
	V15160K17	1.5	Single	60	1755	10.1	6.9	24	20	69	265
H2130K17		2	Single	30	1740	12.5	8.4	42	20	37	260
	V2130K17	2	Single	30	1740	12.5	8.4	24	20	59	235
H2160K17		2	Single	60	1740	12.5	8.4	52	20	41	285
	V2160K17	2	Single	60	1740	12.5	8.4	24	20	68	265

3 HP SINGLE-STAGE MODELS / SPECS

MODEL		HP	PHASE	TANK SIZE (GAL.)	MOTOR RPM	DISPL. CFM @ 100 PSI	DEL'D CFM @ 100 PSI	LENGTH (IN.)	WIDTH (IN.)	HEIGHT (IN.)	APPROX. SHIPPING WT. (LB.)
HORIZONTAL	VERTICAL										
H3130K18		3	Single	30	3450	13.8	11.9	42	20	38	260
	V3130K18	3	Single	30	3450	13.8	11.9	25	20	60	235
H3160K18		3	Single	60	3450	13.8	11.9	52	20	42	285
	V3160K18	3	Single	60	3450	13.8	11.9	24	20	70	265
H3330K18		3	Three	30	1740	13.8	11.9	42	20	38	260
	V3330K18	3	Three	30	1740	13.8	11.9	24	20	60	260
H3360K18		3	Three	60	1740	13.8	11.9	52	20	42	290
	V3360K18	3	Three	60	1740	13.8	11.9	24	20	70	290

3 HP TWO-STAGE MODELS / SPECS

MODEL		HP	PHASE	TANK SIZE (GAL.)	MOTOR RPM	DISPL. CFM @ 175 PSI	DEL'D CFM @ 175 PSI	LENGTH (IN.)	WIDTH (IN.)	HEIGHT (IN.)	APPROX. SHIPPING WT. (LB.)
HORIZONTAL	VERTICAL										
H3330K24		3	Three	30	1740	14.6	10.7	42	20	39	325
H3360K24		3	Three	60	1740	14.6	10.7	52	20	43	400
	V3360K24	3	Three	60	1740	14.6	10.7	30	20	71	390
	V3380K24	3	Three	80	1740	14.6	10.7	30	24	71	440



MODEL - V5160PT03X



MODEL - V5180K30

5 HP SINGLE & TWO-STAGE MODELS / SPECS

MODEL		HP	PHASE	TANK SIZE (GAL.)	MOTOR RPM	DISPL. CFM @ 175 PSI	DEL'D CFM @ 175 PSI	LENGTH (IN.)	WIDTH (IN.)	HEIGHT (IN.)	APPROX. SHIPPING WT. (LB.)
HORIZONTAL	VERTICAL										
H5130K24X		5	Single	30	3450	14.6	10.7	42	20	39	315
H5160K24X		5	Single	60	3450	14.6	10.7	52	20	45	385
	V5160K24X	5	Single	60	3450	14.6	10.7	30	20	73	375
	V5180K24X	5	Single	80	3450	14.6	10.7	30	24	73	440
	V5160PT03X	5	Single	60	3450	21.1*	16.0*	24	20	70	298

*The pump used on this model is a single-stage pump. The CFM is rated @ 100 PSI.

5 HP TWO-STAGE INDUSTRIAL MODELS / SPECS

MODEL		HP	PHASE	TANK SIZE (GAL.)	MOTOR RPM	DISPL. CFM @ 175 PSI	DEL'D CFM @ 175 PSI	LENGTH (IN.)	WIDTH (IN.)	HEIGHT (IN.)	APPROX. SHIPPING WT. (LB.)
HORIZONTAL	VERTICAL										
H5160K28		5	Single	60	1740	20.6	15.3	52	20	47	414
	V5160K28	5	Single	60	1740	20.6	15.3	30	20	75	404
	V5180K28	5	Single	80	1740	20.6	15.3	30	24	75	469
H5112K28		5	Single	120	1740	20.6	15.3	72	30	51	649
	V5112K28	5	Single	120	1740	20.6	15.3	40	30	72	639
H5360K28		5	Three	60	1740	20.6	15.3	52	20	47	409
	V5360K28	5	Three	60	1740	20.6	15.3	30	20	75	399
	V5380K28	5	Three	80	1740	20.6	15.3	30	24	75	464
H5312K28		5	Three	120	1740	20.6	15.3	72	30	51	645
	V5312K28	5	Three	120	1740	20.6	15.3	40	30	72	635
H5160K30		5	Single	60	1740	23.1	18.0	52	20	49	435
	V5160K30	5	Single	60	1740	23.1	18.0	30	20	77	430
	V5180K30	5	Single	80	1740	23.1	18.0	30	24	77	495
H5112K30		5	Single	120	1740	23.1	18.0	72	30	53	675
	V5112K30	5	Single	120	1740	23.1	18.0	40	30	74	665
H5360K30		5	Three	60	1740	23.1	18.0	52	20	49	425
	V5360K30	5	Three	60	1740	23.1	18.0	30	20	77	420
	V5380K30	5	Three	80	1740	23.1	18.0	30	24	77	490
H5312K30		5	Three	120	1740	23.1	18.0	72	30	53	665
	V5312K30	5	Three	120	1740	23.1	18.0	40	30	74	660

7.5 HP TWO-STAGE MODELS / SPECS

MODEL		HP	PHASE	TANK SIZE (GAL.)	MOTOR RPM	DISPL. CFM @ 175 PSI	DEL'D CFM @ 175 PSI	LENGTH (IN.)	WIDTH (IN.)	HEIGHT (IN.)	APPROX. SHIPPING WT. (LB.)
HORIZONTAL	VERTICAL										
H75160K30		7.5	Single	60	1740	32.3	23.5	52	20	49	512
	V75180K30	7.5	Single	80	1740	32.3	23.5	30	24	77	562
H75112K30		7.5	Single	120	1740	32.3	23.5	72	30	53	682
	V75112K30	7.5	Single	120	1740	32.3	23.5	40	30	74	697
H75360K30		7.5	Three	60	1740	32.3	23.5	52	20	49	507
	V75380K30	7.5	Three	80	1740	32.3	23.5	30	24	77	557
H75312K30		7.5	Three	120	1740	32.3	23.5	72	30	53	677
	V75312K30	7.5	Three	120	1740	32.3	23.5	40	30	74	692
H75160K50		7.5	Single	60	1740	30.4	23.7	52	26	52	580
	V75180K50	7.5	Single	80	1740	30.4	23.7	30	26	80	630
H75112K50		7.5	Single	120	1740	30.4	23.7	72	30	56	750
	V75112K50	7.5	Single	120	1740	30.4	23.7	40	32	77	765
H75360K50		7.5	Three	60	1740	30.4	23.7	52	26	52	575
	V75380K50	7.5	Three	80	1740	30.4	23.7	30	26	80	625
H75312K50		7.5	Three	120	1740	30.4	23.7	72	30	56	750
	V75312K50	7.5	Three	120	1740	30.4	23.7	40	32	77	760



MODEL - V75380K50



MODEL - H10312K60

10 HP TWO-STAGE MODELS / SPECS

MODEL		HP	PHASE	TANK SIZE (GAL.)	MOTOR RPM	DISPL. CFM @ 175 PSI	DEL'D CFM @ 175 PSI	LENGTH (IN.)	WIDTH (IN.)	HEIGHT (IN.)	APPROX. SHIPPING WT. (LB.)
HORIZONTAL	VERTICAL										
H10160K50		10	Single	60	1740	40.2	32.4	52	23	52	650
H10112K50		10	Single	120	1740	40.2	32.4	72	30	56	830
	V10112K50	10	Single	120	1740	40.2	32.4	40	28	77	820
H10360K50		10	Three	60	1740	40.2	32.4	52	23	52	635
H10312K50		10	Three	120	1740	40.2	32.4	72	30	56	815
	V10312K50	10	Three	120	1740	40.2	32.4	40	28	77	805
H10160K60		10	Single	60	1740	41.1	33.7	52	25	50	680
H10112K60		10	Single	120	1740	41.1	33.7	72	30	54	860
	V10112K60	10	Single	120	1740	41.1	33.7	40	30	75	850
H10360K60		10	Three	60	1740	41.1	33.7	52	25	50	665
H10312K60		10	Three	120	1740	41.1	33.7	72	30	54	895
	V10312K60	10	Three	120	1740	41.1	33.7	40	30	75	830



MODEL - H15312K60



MODEL - 13GR30HK30

15 & 20 HP TWO-STAGE MODELS / SPECS

MODEL	HP	PHASE	TANK SIZE (GAL.)	MOTOR RPM	DISPL. CFM @ 175 PSI	DEL'D CFM @ 175 PSI	LENGTH (IN.)	WIDTH (IN.)	HEIGHT (IN.)	APPROX. SHIPPING WT. (LB.)
H15312K60	15	Three	120	1740	58.4	46.2	72	30	54	984
H15320K60	15	Three	200	1740	58.4	46.2	76	36	60	1284
H15312K100	15	Three	120	1740	60.7	47.3	72	30	58	1095
H15320K100	15	Three	200	1740	60.7	47.3	76	36	64	1395
H20312K100	20	Three	120	1740	75.8	58.4	72	30	58	1150
H20320K100	20	Three	200	1740	75.8	58.4	76	36	64	1450

GAS - SINGLE & TWO-STAGE MODELS / SPECS

MODEL	HONDA ENGINE RATING	TANK SIZE (GAL.)	ELECTRIC START	DISPL. CFM @ 175 PSI	DEL'D CFM @ 175 PSI	LENGTH (IN.)	WIDTH (IN.)	HEIGHT (IN.)	APPROX. SHIPPING WT. (LB.)
5GR30HK17	163 cc (GX160)	30	Optional	13.1*	8.7*	42	22	38	250
13GR30HK30	389 cc (GX390)	30	Standard	29.5	23.0	42	22	48	367
13GR60HK30	389 cc (GX390)	60	Standard	29.5	23.0	52	26	52	495
13GRBMHK30	389 cc (GX390)	Base Mount	Standard	29.5	23.0	38	20	32	295
20GRBMHK60	688 cc (GX630)	Base Mount	Standard	41.0	33.7	53	29	32	435
20GR60HK60	688 cc (GX630)	60	Standard	41.0	33.7	64	30	50	585

*The pump used on this model is a single-stage pump. The CFM is rated at 100 PSI.

**Other engines available - consult factory.

**Base-Mount units are equipped with either 4.5 gallon surge tank or 9 gallon twin-tank assembly, dependent on model.

**Battery tray optional on all gas models (battery and electric-start cables are not included).



PUMP SPECS

	K17	MK103	MK113	K18	PT03A	K24	K28	K30	K50	K60	K100
Horsepower - Electric	1.5 - 3	1.5 - 3	2 - 4	2-3	5	3 - 5	3 - 5	5 - 7.5	7.5 - 10	10 - 15	15 - 20
Engine Rating - Gas	163 cc	163 cc	-	198 cc	389 cc	270 cc	270 cc	389 cc	-	688 cc	-
RPM - Electric	1.5 HP-800 2 HP-1000 3 HP-1200	1.5 HP-900 3 HP-1400	2 HP-900 4 HP-1400	2 HP - 800 3 HP-1200	5 HP 1200 -	3 HP-850 5 HP-1000	5 HP - 1265 -	5 HP-900 7.5 HP-1260	7.5 HP-800 10 HP-1135	10 HP-800 15 HP-1140	15 HP-800 20 HP-1000
RPM - Gas	GX160-1100	GX160-1100	- -	- -	- -	- -	GX340-1265	GX340-850 GX390-1150	- -	GX630-900	- -
Max. Pressure (PSI)	150	145	145	150	150	200	200	200	200	200	200
Cylinders	2	2	2	2	3	2	2	2	2	4	4
Bore L.P. (inches)	2.52	2.56	2.56	2.75	2.56 x 3	3.54	3.74	4.13	4.72	4.13 x 2	4.72 x 2
Bore H.P. (inches)	-	-	-	-	-	1.97	1.97	2.05	2.36	2.05 x 2	2.36 x 2
Stroke (inches)	1.97	1.57	2.28	1.97	1.89	2.56	2.56	3.31	3.74	3.31	3.74
Flywheel Dia. (inches)	11.00	10.1	12.3	11.00	10.50	15.16	15.16	15.16	17.72	17.72/ 21.65	21.65
V-Belts	1-A	1-A	1-A	1-A	1-A	2-A	2-A	2-A	2-B	2-B	2-B
Shipping Weight (lb.)	38	22	39	42	63	58	70	90	186	232	343
Intake (inches)	.50	.75	.75	.50	.50	.50	.75	.75	1.00	.75 x 2	1.00 x 2
Discharge (inches)	.50	.50	.50	.50	.50	.50	.75	.75	1.25	1.00	1.25
Oil Capacity (oz.)	34	17	30	34	24	61	61	47	59	98	127

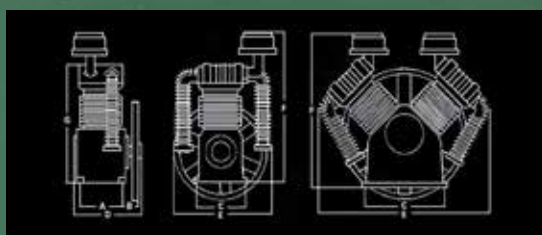

PUMP DIMENSIONS (IN INCHES)

	A	B	C	D	E	F	G
K17	5.19	3.94	7.08	10.24	11.50	14.17	13.77
MK103	4.72	2.99	6.30	10.41	10.16	11.56	-
MK113	5.12	3.54	7.48	12.0	12.28	14.17	-
K18	5.19	3.94	7.08	10.43	12.60	14.76	14.56
K24	6.41	3.94	8.09	12.20	15.16	16.33	16.33
K28	6.41	3.94	8.09	12.20	15.16	20.47	16.33
K30	7.48	5.31	8.97	14.17	16.33	22.24	18.70
K50	8.26	6.30	11.41	16.53	18.11	25.98	22.04
K60	9.60	6.30	11.73	17.52	28.93	23.62	19.29
K100	11.14	7.48	15.27	20.47	35.03	27.55	22.83
PT03A	5.88	4.13	8.63	13.00	18.30	13.05	13.00

*Many other pumps available, consult factory for information.



ROLAIR SYSTEMS
606 SOUTH LAKE STREET, P.O. BOX 346
HUSTISFORD, WI 53034-0346
P 920.349.3281 F 920.349.8861
ROLAIR.COM

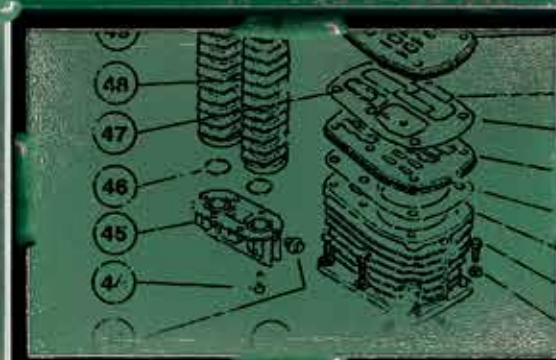

ROLAIR.COM 920.349.3281

