

**ROLAIR**  
 SCHEMATIC FOR  
 PMP12K35

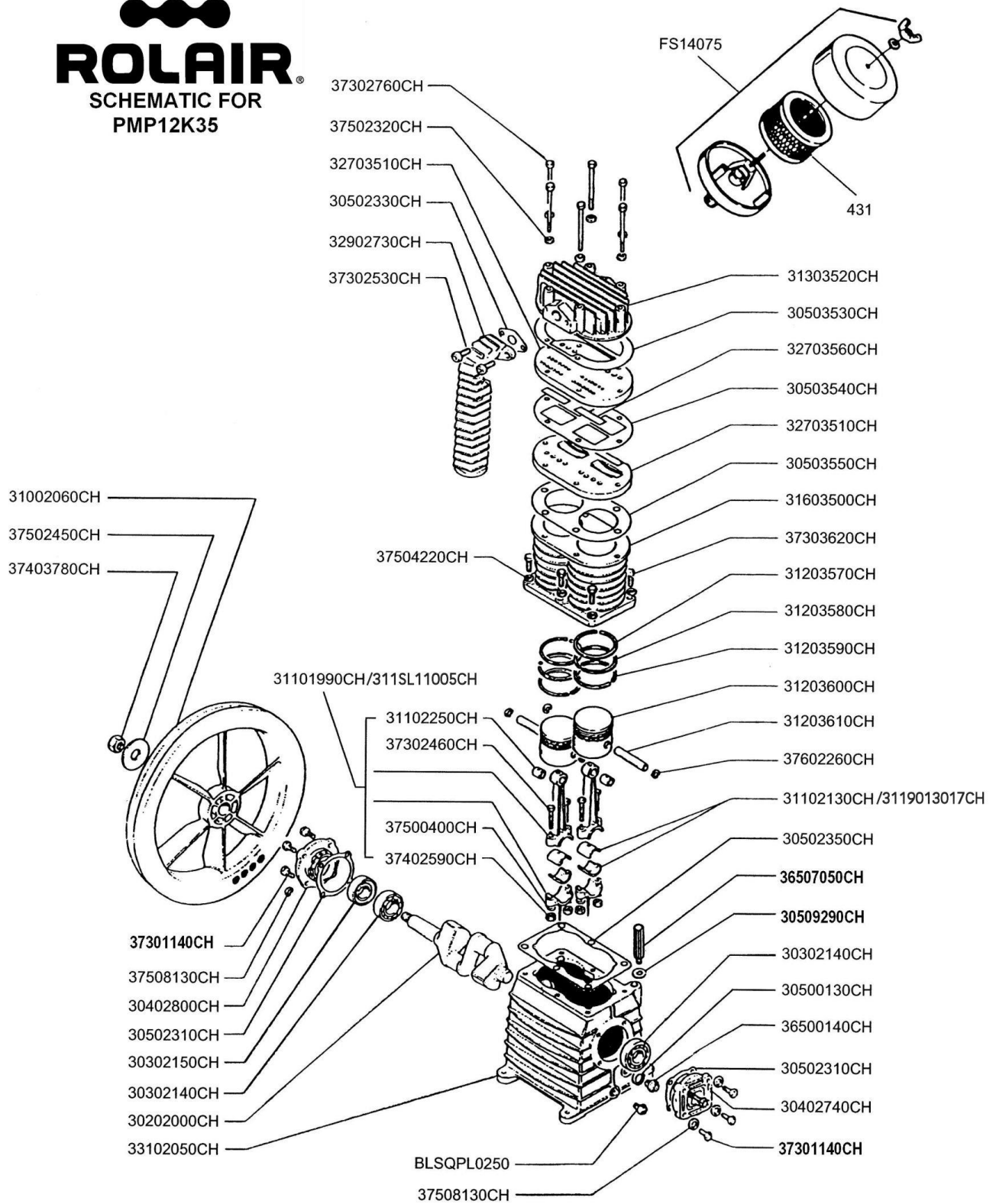

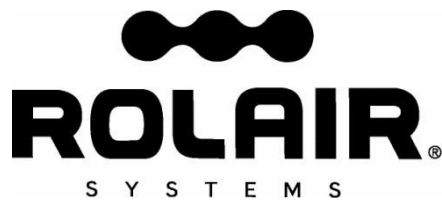

## PARTS LIST FOR PMP12K35

Description	Part #	Qty.	Description	Part #	Qty.
Crankshaft	30202000CH	1	Head	31303520CH	1
Bearing	30302140CH	2	Cylinder	31603500CH	1
Oil Seal	30302150CH	1	Valve Plate	32703510CH	2
Bearing Carrier	30402740CH	1	Valve	32703560CH	8
Bearing Carrier	30402800CH	1	Aftercooler	32902730CH	1
Gasket	30500130CH	1	Crankcase	33102050CH	1
O-Ring	30509290CH	1	Sight Gauge	36500140CH	1
Gasket	30502350CH	1	3/8" Breather/Oil Fill Plug	36507050CH	1
Gasket	30502310CH	2			
Gasket*	30502330CH	1	Bolt	37301140CH	8
Gasket	30503530CH	1	Bolt	37302460CH	4
Gasket	30503540CH	1	Bolt	37302530CH	2
Gasket	30503550CH	1	Bolt	37302760CH	6
Flywheel	31002060CH	1	Bolt	37303620CH	6
Connecting Rod w/Upper Bushing	31101990CH	NLA	Nut	37402590CH	4
			Nut	37403780CH	1
Connecting Rod w/Upper Bushing ***	311SL11005CH	2	Washer	37508130CH	8
			Washer	37500400CH	4
Bearing Shell (for 31101990CH connecting rod)	31102130CH	2	Washer	37502320CH	6
			Washer	37502450CH	1
Bearing Shell (for 311SL11005CH connecting rod)	3119013017CH	2	Washer	37504220CH	6
			Snap Ring	37602260CH	4
			Filter Element	431	1
Bushing **	31102250CH	2	Plug	BLSQPL0250	1
Ring	31203570CH	2	Silencer/Filter Assembly	FS14075	1
Ring	31203580CH	2	Ring Set	K35RINGS	1
Ring	31203590CH	2	Gasket Set	K35GASKETS	1
Piston	31203600CH	2	Valve Plate Assembly	3500VK35	1
Piston Pin	31203610CH	2			

\*Pumps produced after January 2005 use a 30502500CH O-Ring.

\*\*Bushing is not machined to fit piston pin if ordered separate from connecting rod and must be bored to .005" over O.D. of piston pin after being pressed into place (For connecting rod with casting number of 31101990 only).

\*\*\*Has casting number of SL11165. Must order 311SL11005CH1 connecting rod assembly when replacing 31101990CH rod. Bearing shells used in 31101990CH and 311SL11005CH connecting rods are not interchangeable.

